

History Lesson

Washington Elementary School was built as part of the town's response to the infamous Ninth District School fire on Oct. 23, 1913.

Although all of the 1,000 students and teachers in the Ninth District School were able to get out without harm that day, the building – which is at the site of what is now Bennet Academy – burned to the ground.

Washington opened in April 1915 (yes, three-quarters of the way through the school year) having been built – hastily but sturdily, for \$62,237 – on a four-acre lot bounded by Pleasant, Cooper, Cooper Hill and Cedar streets. It served a West Side that was growing rapidly and would continue to do so for years, with many of the residents employed by the sprawling Cheney Brothers manufacturing empire.

In 1921, the West Side Rec opened just to the south of the school, and athletes of all ages spent hours in the Rec and on the adjacent fields. A parking lot separated the two buildings and students would have to walk outdoors from the school to the Rec, which had in addition to a gymnasium a small duck-pin bowling alley.

In 1958, an addition was built connecting the school building and the Rec, and 20 years later the Rec was razed and rebuilt – reopening in 1979 and dedicated soon thereafter (in 1981) in honor of Francis Mahoney, a former mayor (1962-66) and state representative (1968-80).

Washington Elementary School is closing in June 2019 as part of a multifaceted upgrade of elementary schools throughout the district. Its future use has not been determined.



Washington Elementary School
Manchester, CT *May 16, 2019*
1915 - 2019 *Open House*



Self-Guided Tour

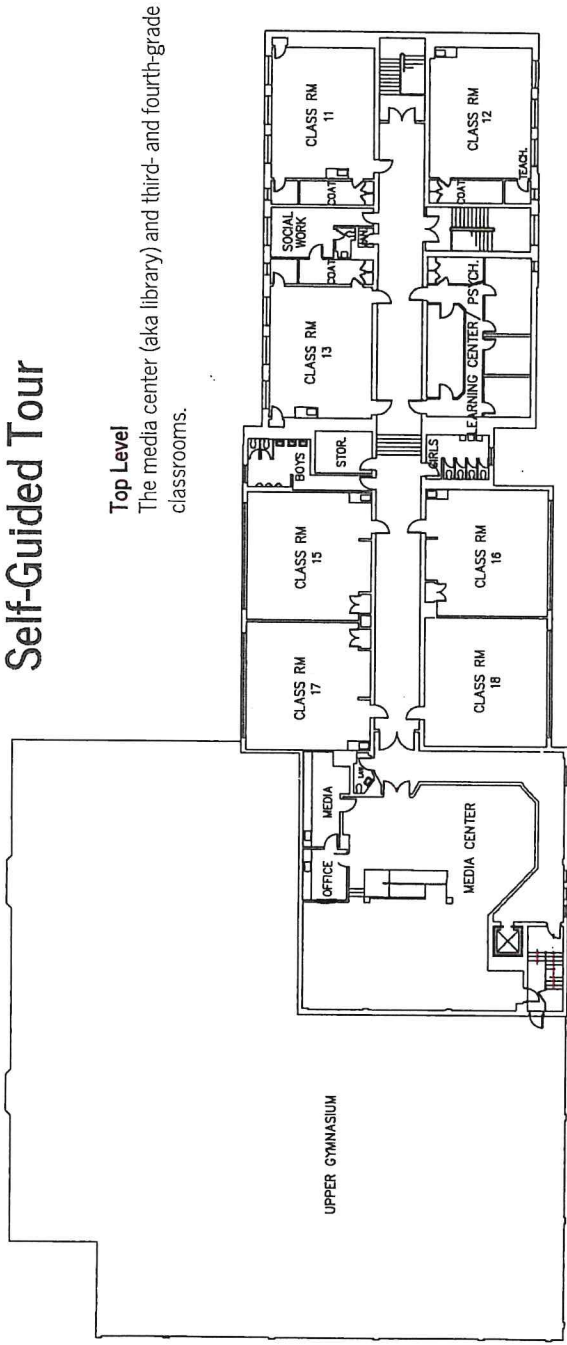

Top Level

The media center (aka library) and third- and fourth-grade classrooms.

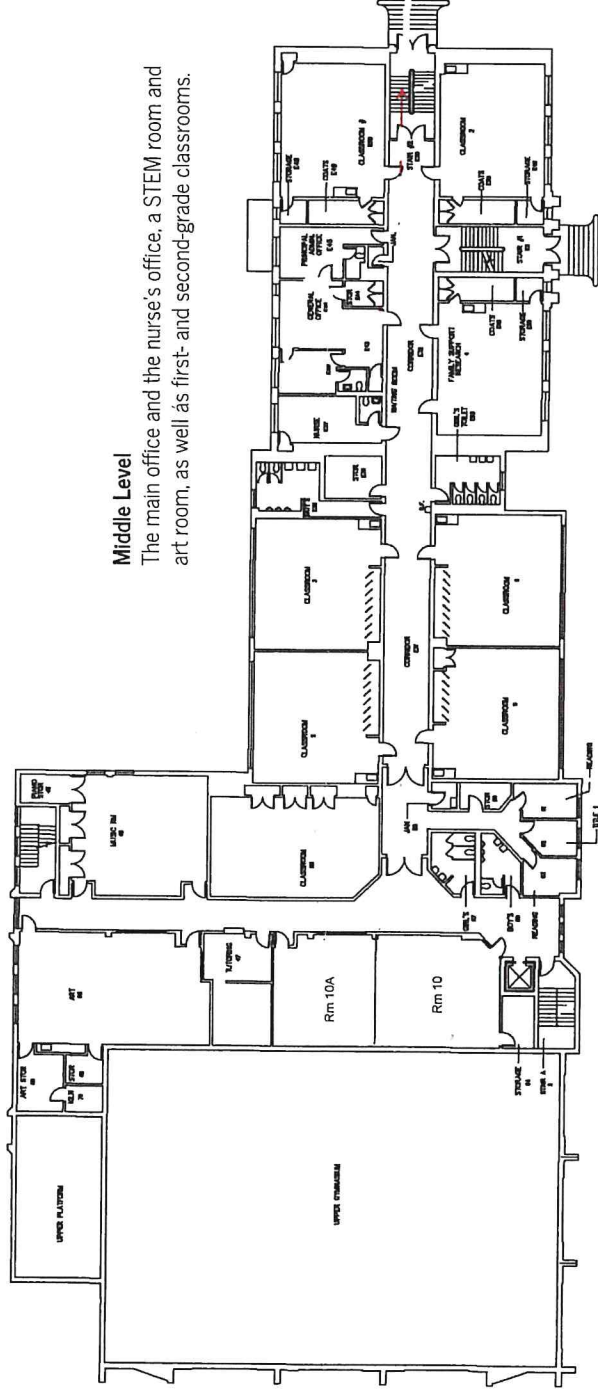

Middle Level

The main office and the nurse's office, a STEM room and art room, as well as first- and second-grade classrooms.

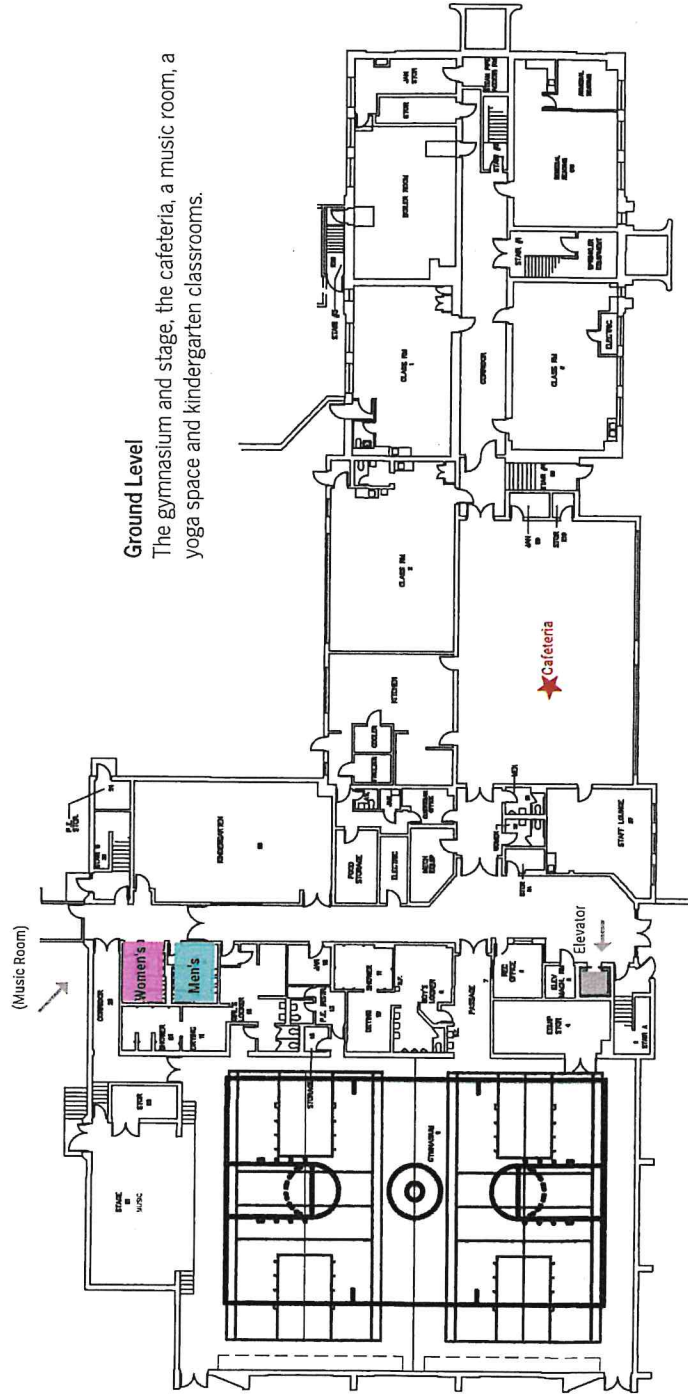

Ground Level

The gymnasium and stage, the cafeteria, a music room, a yoga space and kindergarten classrooms.

S

Simonetti, Marie
 Shaw, Beth -- teacher (1970s)
 Shea, Catherine C. -- principal (1937-1950)
 Skoog, Jessica -- tutor/teacher (2006-2008)
 Sloan, Trisha
 Sorenson, Cortney
 Smith, Dolly -- teacher (1960s)
 Smith, Dorthea -- teacher (1960s)
 Smith, Tina
 Smyth, Jenifer -- teacher (2007-2013)
 Smith, Rosemary -- teacher
 Smutko, Krysten
 Soto, Victor
 Spencer, Avery
 Spencer, Nancy
 Spiwak, Grace
 Spooner, Mrs. -- secretary
 Steffenson, Julie -- teacher (2010-2015)
 Streeter, Debbie -- para (1996)
 Stickie, Nicole
 Sullivan, R. J.
 Suito, Sarah
 Strickland, Tom
 Sultan, Hassan
 Swan, Jane -- library para
 Swartz, Priscilla
 Swayner, John
 Sweeney, Julie
 Sweeney (Shea), Lucy -- teacher (1964-1965)

Since it opened in 1915, thousands of people have worked at Washington Elementary School and many are listed here. If you know of someone or something we've missed, please jot notes below or in the margins. You can leave this program in the media center or main office before you leave today, or share information later with Jim Farrell, the district communications director, at bljfarf@mpspride.org or 860-268-6377. We will post a 'final version' on the district Facebook page and give a copy to the Manchester Historical Society.

Notes:**I**

Tamsin, Elizabeth -- teacher (1984-1994)
 Tanner, Laura
 Thompson, Colleen
 Tenor, Eleanor -- teacher (1975-1985)
 Tierney, Mary
 Tluck, Joan
 Tonzi, Sarah
 Torsiello, Vicky -- teacher (1970s)
 Treadwell, Mrs. (~1967)
 Trombly-Santoro, Michele
 Trovato, Carla -- (2013-2019)
 Tryon, Sharon
 Turnquest, Latasha -- (2007-2014)
 Trymbulak (sp?), Mrs. -- teacher (late 1980s)
 Tynan, B. -- teacher (1920s)
 Tyne, Linda

U

Uzepes, Mrs. -- teacher (1960s)

V

Viani, Charles -- teacher
 Valencia, Marisela
 Vernacatola, Dottie
 Visney, Bob -- teacher (~1950s-1990s)

W

Wade, Janette -- para (late 1980s)
 Webster, Doris -- teacher (1965-1967)
 Weerden, Jenna -- lunch aid
 Weerden, Leslie -- lunch aid
 Welch, M. M. -- among first Washington teachers (1915-19xx)
 Weiss, Joan
 Weyrauch, Tom
 Whaley, Joseph -- MELC (2013-2015)
 Whaley, Laura -- noon aid/after school program
 Wheeler, Miss (1940s)

W

White, Cheryl
 White, Sharon
 Whitehouse, Ann
 Wilhelm, Sharon
 Wilcox, Michele
 Williams, Joanne
 Williams, Mr. -- teacher (1980s)
 Womack, Cynthia -- principal (1999-2010)
 Woodell, Jan
 Wooding, Chuck
 Woodworth, E. -- among first Washington teachers (1915 - 19xx)

Y

Yeshe, Jennifer
 Young, Mike

Z

Zadnik, Jane -- para (late 1980s)
 Zadrozny, Milla
 Zulick-Bessette, Patty

Washington Staff Reunion

Thursday, May 16, 2019

Welcome back! There will be a brief ceremony in the media center at 5:15 p.m. and after that we will be taking various group photos that will be shared on the district Facebook page (MPSPrize). The times and locations of the group photos will be announced over the PA system.

Today's staff reunion runs until 6 p.m. and will be followed by a community open house that ends at 8 p.m. We hope you can stick around a bit and perhaps reconnect with some former students.

Also, tonight at 6:15 and 7:15, Town Historian Susan Barlow will give brief presentations about the history of Washington Elementary School. These will take place in the cafeteria.

Finally, this all-time Washington employee list is a work in progress. See the back page for how you can help us make it more comprehensive and accurate.

B

Brihan, Sarah (2018-2019)
 Brooks, Sandra
 Brown, Trevon
 Brunner, (Miss Benson) Mrs. -- teacher (1930s-1940s)
 Bryce, Lisa
 Bryce, Roberta -- teacher (1980s)
 Buckland, Mary
 Busque, Diane
 Bussman, Miss -- teacher (1940s)

C

Canes, Bonnie
 Carabillo, Greg
 Caruso, Georgia
 Caskey, Nicole
 Charnas, Joan -- counselor, administrator (2012-2019)
 Charter, Beth -- secretary
 Chenette, Nancy -- teacher
 Chojnicki, Elizabeth (2018-2019)
 Christian, Jessica (2012-2019)
 Citrone, Lorriane
 Clark, Andrea (2010-2014)
 Cleary, Kim -- teacher (1995)
 Clifford, Christine -- volunteer library aid (1980s)
 Clough, Meg (2008-2012)
 Colburn, Kim
 Collin, Jim -- principal (2015-2017)
 Colwell, Joseph
 Constantios, Adam
 Cooper, Debbie
 Cornog, Diane
 Costello, Katherine
 Coughlin, Jim
 Cowen, Judy. -- teacher (late 1980s-1990s)
 Crawford, J. -- teacher (1920s)
 Crosby, Ann
 Crudden, Jessica (2008-2018)
 Cullen, Christine
 Culver, Karen
 Curley, Ann
 Cyz, Susan

A

Abbott, Brianna
 Abele, Caroline
 Adams, Jen
 Adams, L. -- teacher (1920s)
 Adams, Linda
 Allabaugh, Mary
 Anderson, Betsy -- teacher
 Archer (Saretski), Libby -- teacher (1947- 19xx)
 Atwood, Harriet -- teacher (1940s)
 Axelson, Roland -- interim co-principal (2013)
 Axler, Elaine

E

Baker, Gertrude F -- (1960s)
 Banning -- teacher (1954-1959+?)
 Barry, Christine -- grade 2 teacher (1999-2000)
 Bauer, Sarah
 Barrera, Sandra
 Bazzano, Ginny -- teacher (1970s)
 Bensch, Edward -- principal (1954-1958)
 Bengs, E. M. -- among first Washington teachers (1915-1922+)
 Best, Zerrica -- tutor (2000-2018)
 Bialeck, Margi
 Bjornberg, R -- teacher (1920s)
 Bloomquist, Laura
 Blum, Christina
 Bolac, Mr. -- teacher (~1960s)
 Boland, Mary -- nurse
 Bon, Radican
 Booth, Helena -- teacher (1930s-1940s)
 Borowski, E. -- among first Washington teachers (1915-19xx)
 Bouthiller, Matthew (2019)
 Brand, Dorothy
 Breault, Jen
 Brennan, Ms. -- student teacher (1988)
 Brice, Lisa -- para

D

Dahms, Debbie
 Daley, Erika
 Darna, Betty -- teacher (1970s-1990s)
 Davis, Mike
 Dean, Christie
 Deffley, Mary
 DeForest, Amy --para
 Dehm, Jean (2008-2018)
 Dell, Ann -- teacher (~1972-1991+?)
 DeNies, Marie
 Dihlman, Linda -- reading consultant
 DiTarando, Carl --custodian (1970s)
 Dolan, Mrs. -- teacher (1980s)
 Drugan, Nikarra
 Dugas, Diane -- principal (1998-1999)
 Dukas, Christine
 Dupuis, Kim
 Duva, Paul -- teacher (2007-2008)
 Dyer, Kathy -- teacher (1970s)

E

Ekstrom, Sarah (2008-2011)
 English, Lindsay
 Everett, Shelly

F

Fagan, Rebecca (1998-2007)
 Fallicaro, Joe
 Farrell, Kathleen
 Faulkner, Julie. -- teacher (1950s-1960s)
 Fegy, Mrs. -- secretary
 Fellenstein, Carol
 Fennimore, Nathaniel
 Ferrante, John
 Ferreira, Kathleen -- social worker (1987-1991)
 Fiedler, Karen
 Fish, Carol -- teacher (1970s)
 Fleming, Mary
 Flores, Iris -- para (2015)
 Flynn, An'drea (1997-2019)
 Formica-Burnham, Elaine
 Fountain, Felicia
 Fox (Plummer), Sandy
 Fraser, E. -- teacher (1920s)
 Fredette -- teacher (early 1960s)
 Frenchette, Fred -- teacher (1960s)
 Frosti, Mayra
 Fuini, Ann -- assistant principal (2007-2008)
 Furlong, A. -- teacher (1920s)

G

Gallagher, Debbie -- teacher (~1973-1976)
 Gardiner, Ray -- principal (1985-94?)
 Gardiner (Conpask), Donna
 Garrison, Ken -- teacher (2008-2015)
 Gasper, Linda
 Giaquinto, Christine
 Gibson, Robin (2006-2008)
 Giroux, Jennifer
 Gordon, Brian
 Gorman, Alice G. -- teacher (1930s)
 Gorman, Helen -- teacher (1930s)
 Gray, Karen -- principal (2010-2015 and 2017-2019)
 Greene, Mrs. -- cafeteria (1980s)
 Griffin, Polly

H

Hahn, Rachel
 Hall, Brittany -- FRC (2010-11, 2015-16)
 Hanna, Lenora -- first principal (1915-1937)
 Harbec, Kate

H

Hayes, Beverly
 Hazzard, Erin
 Hebert, Joanne
 Heins, Robert -- principal (1975-1979)
 Hendrickson, Ms.
 Hensig, E. -- teacher (1920s)
 Herchuk, Carly
 Hernandez, Glenda -- (2005-2013)
 Herzog-Alfonso, Marcie
 Hilliard (Conway), Linda
 Hilton-Rang, Candace -- para (2003-2005)
 Holle, Katharine -- occupational therapist (2018-2019)
 Horila, Jill
 Hoss, Carly
 Howard, (Carter), Edna -- teacher (1930s)
 Hughes, Brian
 Hyatt, Ashley

I

Iacovelli, Jane
 Indomenico, Donna -- reading and language arts consultant
 Irwin, Pat
 Itsou, Stacey

J

Jacques, Elisabeth -- social worker (2014-2015)
 Jennings (Kenny), Winifred -- teacher (1930s)
 Johnkoski, Janina
 Johnson, Annie
 Jones, Janice -- teacher
 Jones, Theresa -- teacher (20xx-2019)
 Jordan, Sarah

K

Kantrow, Kate -- teacher (2013-2019)
 Kearney, Diane
 Kellogg, Jean
 Kelson, Charles -- teacher (~1950s-1980s)
 Kenefick, Marcia -- principal (1979-1984)
 Kenyon, Arline -- teacher (1970s)
 Kerkin-Bundy, Lisa -- music (1984-1992)
 Kilgus (Horila), Jill -- teacher (1997-2001)
 King, Deryann
 Kingsbury, Jean -- teacher
 Klute, Karen (?) -- student teacher (1988)
 Knight, Melissa
 Kolek, Jamie -- (2015-2018)
 Korb, Charity -- social worker
 Koski, Millie -- teacher (~1972-1996)
 Kosky, "Gram" Francis
 Kovacs, Sharon
 Krajewski, Leigh Ann
 Kratz, Catherine -- teacher (2000-2003)
 Krzywicki, Christina

L

LaForge, David -- custodian
 LaFleur, Brittany
 Langevin, Margaret -- teacher
 Lambert, Sandy -- (1999-2013)
 Lapolla, Linda
 Larco, Laurel
 Lassow, Mrs. (~1963)
 Laughlin, Robert B. -- after school program (2001-2004)
 Lavey, Linda
 Lemay, Matt
 Levesque, Caitlin
 Litwin, Colleen

L

Locust, Kimi
 Long, Darcelle
 Lowe, Cindy
 Luce, Mary
 Lukach, Lynn
 Lunsford, Helen -- teacher (1970s-1990+?)
 Luozi, Danielle

M

Maas, Carol-- teacher
 Maglieri, Tina
 Maicom-Best, Zerria
 Maloney, Diane
 Manno, Mary
 Martinez, Madeline
 Mason, Linda
 Matthews, Shelley-Ann
 Matzdorff, Dot. -- teacher (~1962-1989)
 McCann, Mrs. -- teacher(1960s)
 McCann, (Marlowe) Grace -- teacher (1930s-1940s)
 McCarthy, Bill
 McClean, Nancy
 McCoy (Greene) Stacey -- kitchen (2002-2005)
 McDonnell, Mariel -- (2014-2018)
 McDougal, Bill -- teacher
 Mcguire, Susie
 McKeone, Meaghan
 McKnenerly, (sp?), Lorriane
 McKnight, Michelle -- teacher (2002-2011; 2015-2019)
 Melzen, Emily
 Messecar, Ann
 Meyers, Mary
 Miller, Janet
 Mizia, Elizabeth -- para (2002)
 Modean, Nancy
 Monaco, James -- custodian (1980s)
 Molloy, Alice
 Montstream, Kendra (2004-2013)
 Montanaro, Niki
 Monti, Shalina
 Moore, Rachel
 Morin, Kate -- teacher (2015-2017)
 Moyer, Marybeth -- teacher
 Mudgett, Joan
 Mullins, Christopher
 Murphy, Barbara (32 years, when?)
 Muro, Candy
 Myers, Mary

N

Nagle, Eric
 Napoletano, Maryann
 Nardone, Danielle
 Negrelli, Dan
 Negron, Bernardo
 Nelson, R. -- teacher (1920s)
 Nudget, Joan
 Nukis, Darlene -- nurse (2018-2019)
 Nyman (Marolt), Olive -- teacher (1930s)
 Nyman (Campagna) Ruth -- (1930s)

O

O'Brien, Karen
 Odom, Annette
 O'Donnell, Joan
 Olseyer, Donna -- teacher (1970s)
 Olson, Mindy -- nurse (20xx-2018)
 Orfittelli, Ethel -- teacher (1959-1986)
 O'Malley, Tammy -- (2003-2012)
 O'Neil, Caitlyn -- occupational therapist
 Owens, Deborah

P

Paterson, Judy -- teacher
 Paklos, Liz
 Pearce, Michael
 Perez, Carmen --behaviorist (early 2000s-2017)
 Perkins, Tanya
 Peterson, Donna
 Petroff, Cheryl
 Phillips, Bryan
 Phillips, Craig
 Piasecki, Sandi
 Picollo, Jackie
 Pike, Dorothy -- teacher (1930s)
 Pinkney, Nancy
 Platz, Janet
 Plenby, Elana
 Pollock, Jillian
 Prager, Bev
 Procko, Tom -- teacher (1980s-1990s)
 Proctor (Briggs), Allegra -- teacher (1930s)

Q

Quaglia, Sue
 Quey, Michelle

R

Ramizi, Vincent -- principal (1950-1954)
 Ramsey, Jessica
 Ransome, H. -- among first Washington teachers (1915-xx)
 Reid, Mrs. -- teacher (1960s)
 Renn, Mrs. -- teacher (1960s)
 Reynolds, Kathleen
 Reynolds, Katey -- teacher (2002-2018)
 Rizza, Frank
 Riedel, Rima -- 1990
 Roach, Mary -- teacher (~1935-1970)
 Robinshaw, Kristina
 Rodriguez, Teresa
 Rogers, Andre
 Rogers, Tiffany
 Rohlfs, Judy -- teacher (1960s-1970s)
 Rohlfs, Linda -- teacher (1960s-1970s)
 Rosenberg, Gail -- teacher (1970s)
 Rosow, Rebecca
 Rossi, Rick -- teacher
 Roth, Walter C. -- principal (1958-1975)
 Rudy, Melissa
 Russell, Ann Marie -- teacher (1970s)
 Russo, Wendy

S

St. Germain, Carey
 Saimond, Mike -- interim co-principal (2013)
 Sabatelli, Cecilia -- teacher (2007-2012)
 Salerno, Kristina
 Santerelli, Rebecca
 Sanzo, Pat
 Sawyer, Kaitlyn
 Scaglione, Charity
 Scanlon, Peg
 Scatta, Joanne. -- teacher (1960s-1970s)
 Schidat, Andrea
 Schofield, Wes -- teacher (2001-2003)
 Schon, Wilhelm
 Scott, M. -- teacher (1920s)
 Seah, Cherie
 Sentivany, Lynn
 Seymour, M. E. -- among first Washington teachers (1915-19xx)
 Siebert, Kara -- teacher (1988-1990s)
 Sikand, Kathleen